

# DS60 BASIC

PYRAMIDAL HYDRAULIC SECTION BENDER

# W

21 cm<sup>3</sup>

FLEXURAL MODULUS

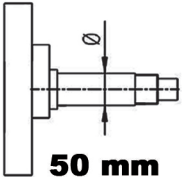

50 mm

ROLLS SHAFTS DIAMETER

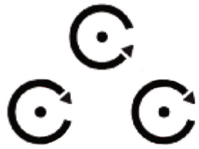

THREE DRIVING ROLLS

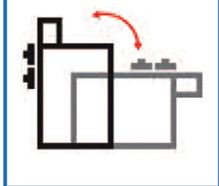

HORIZONTAL - VERTICAL



SIMPLIFIED PUSH BUTTON  
FOR THE TOP ROLL

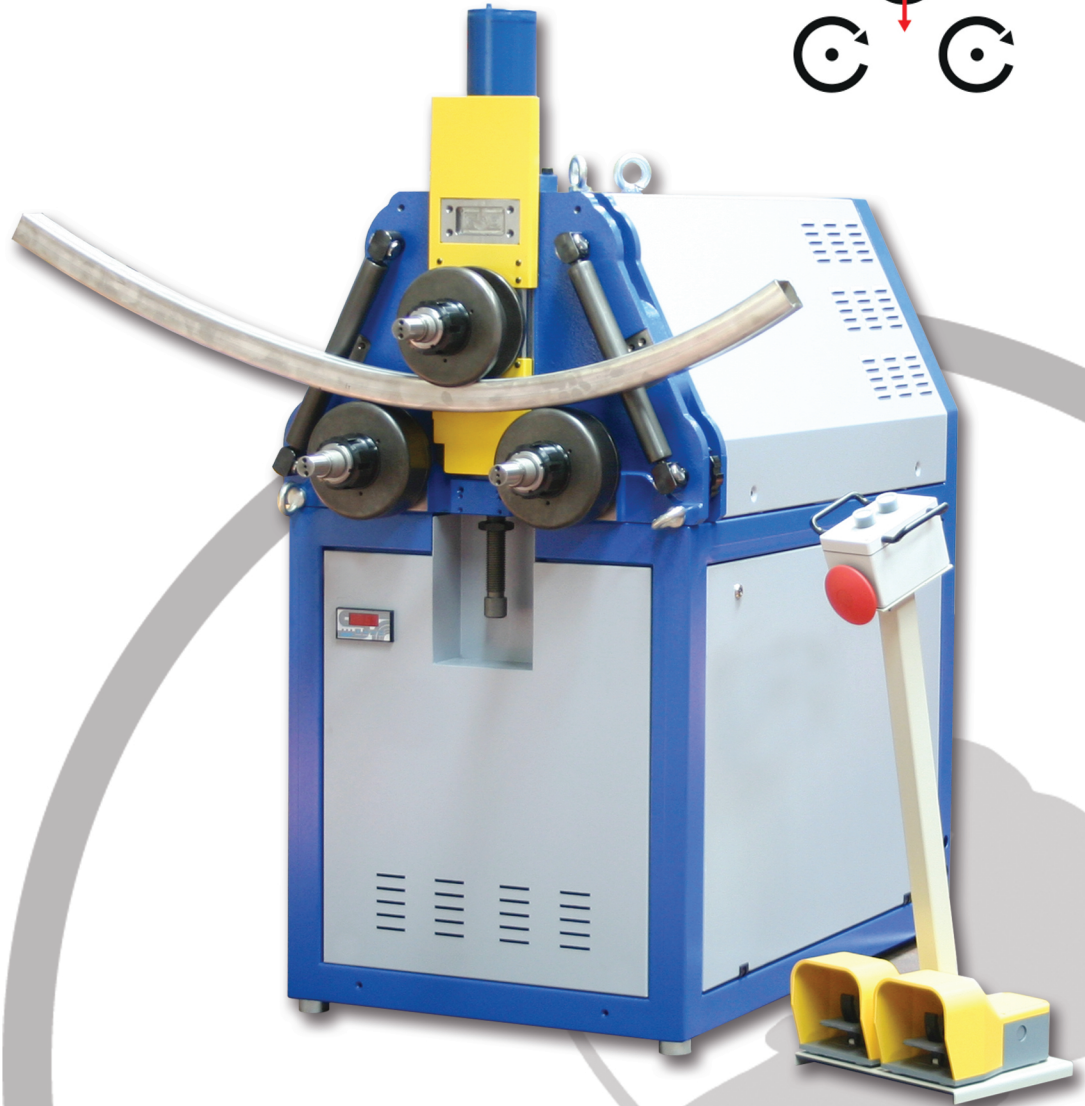
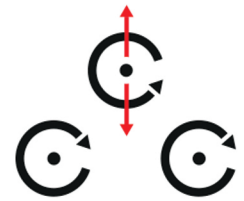

## SR

by tauringroup

**BASIC: THE QUALITY WITHIN  
EVERYONE'S MEANS!**



TAURING S.p.A.  
Via Lombardore, 314  
10040 Leini (TO) - Italy  
Tel. + 39 011.99.77.111  
Fax + 39 011.99.77.169  
info@tauringroup.com

[www.tauringroup.com](http://www.tauringroup.com)

**TECHNICAL DATA**

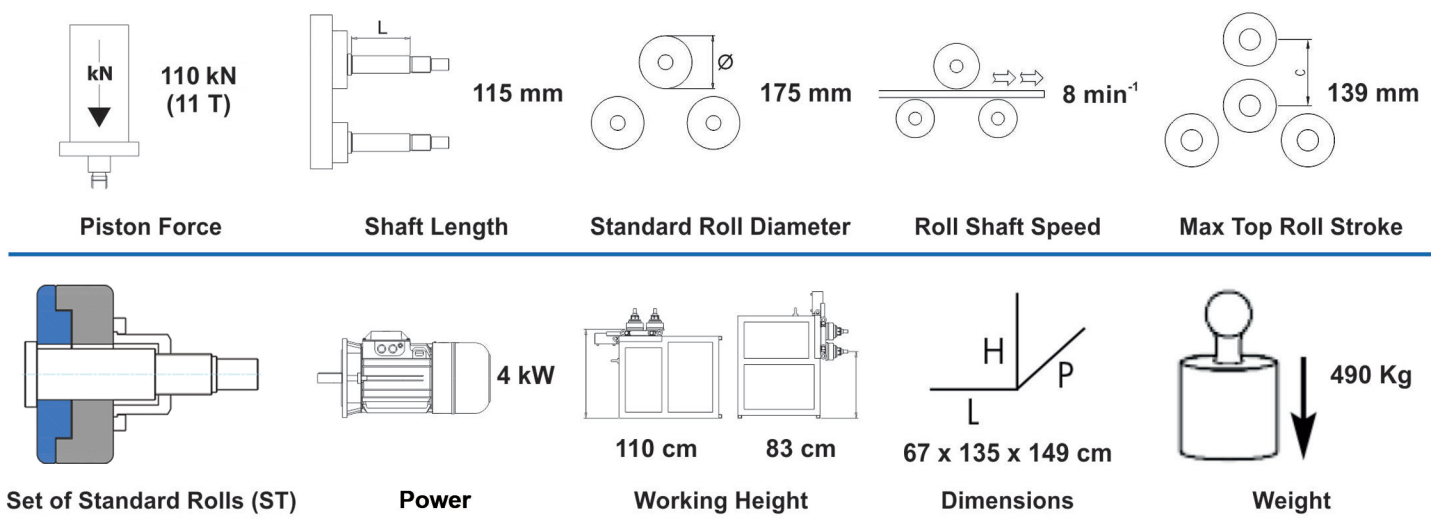

**MAXIMUM BENDING CAPACITIES**

| MATERIAL POSITION | Dimensions in mm   | Min. R.     | Tooling                                 |
|-------------------|--|-------------|---|
| <b>1a</b>         | 75 x 30   60 x 30*<br>100 x 30   80 x 30*                | 250<br>300  | <b>POL</b><br><b>POL - SI</b>           |
| <b>1b</b>         | 65 x 15   50 x 15*<br>70 x 15   60 x 15*                 | 250<br>300  | ST<br>ST - SI                           |
| <b>2a</b>         | 40   35*<br>45   40*                                     | 600<br>1000 | <b>POL</b><br><b>POL - SI</b>           |
| <b>3a</b>         | 50 x 50 x 5<br>60 x 60 x 6                               | 500<br>700  | ST<br>ST - SI                           |
| <b>3b</b>         | 50 x 50 x 5<br>60 x 60 x 6                               | 500<br>700  | ST<br>ST - SI                           |
| <b>5a</b>         | 50 x 50 x 7<br>60 x 60 x 8                               | 250<br>400  | ST<br>ST - SI                           |
| <b>5b</b>         | 50 x 50 x 7<br>60 x 60 x 8                               | 250<br>400  | ST<br>ST - SI                           |
| <b>6a</b>         | UPN 80<br>UPN 100  | 500<br>700  | <b>POL</b><br><b>POL - SI</b>           |
| <b>6b</b>         | UPN 80<br>UPN 100  | 500<br>700  | <b>POL</b><br><b>POL - SI</b>           |
| <b>9a</b>         | 60 x 2   50 x 2*<br>70 x 2   60 x 2*                     | 900<br>1200 | <b>RT</b><br><b>RT - SI</b>             |
| <b>9b</b>         | 2" Gas x 2   1 1/2" Gas x 3<br>2 1/4" x 2   2" Gas x 3   | 600<br>1000 | <b>RT</b><br><b>RT - SI</b>             |
| <b>9c</b>         | 45   40*<br>50   45*                                     | 500<br>900  | <b>RT</b><br><b>RT - SI</b>             |
| <b>10a</b>        | 70 x 40 x 3   60 x 40 x 3*<br>80 x 50 x 3   70 x 40 x 3* | 500<br>1000 | <b>POL / RQ</b><br><b>POL / RQ - SI</b> |
| <b>10b</b>        | 70 x 40 x 3   60 x 40 x 3*<br>80 x 40 x 3   70 x 40 x 3* | 600<br>1000 | <b>POL / RQ</b><br><b>POL / RQ - SI</b> |
| <b>11a</b>        | 60 x 60 x 3   50 x 50 x 3*<br>70 x 70 x 3   60 x 60 x 3* | 900<br>1300 | <b>POL / RQ</b><br><b>POL / RQ - SI</b> |

Please note that the capacities are calculated with Mild Steel (400N/mm<sup>2</sup>) and are merely indicative they can vary without prior notice, so they cannot be considered as binding.

\* : Stainless Steel (600 N/mm<sup>2</sup>).

■ : The items written with red color are optional equipment available upon request.

**FEATURES**

- The 50 mm shafts machine with the best price/quality ratio on the market.
- Robust construction for safe and stable bending process.
- Heat-treated and grounded shafts made of special steel.
- Digital display for the top roll read-out position.
- Hydraulic movement for the top roll and three driven rolls.
- Standard (ST) tooling set included with the machine.
- Mechanical stop of the top roll for higher bending accuracy.
- Remote foot pedal with emergency stop and simplified buttons to move the top roll.
- Horizontal and Vertical working position.
- Lateral straighteners.
- Voltage: 380/400 V – 50 Hz.
- In accordance with the safety regulations and quality standards.

**OPTIONAL EQUIPMENT**

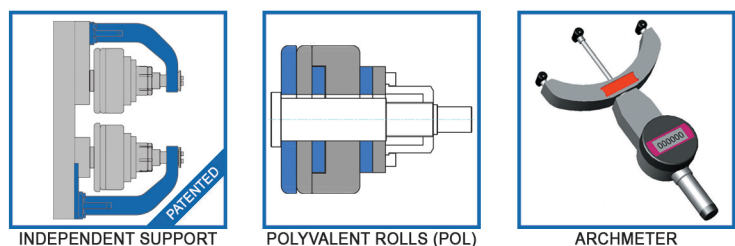

- Second speed.
- Special rolls for tubes and others no standards profiles (SP, RT, RO, RQ.)
- Double adjustment device for "leg-in" angle profiles and other asymmetrical ones (AI.)
- Device for the calibration and the maintenance of constant bending radius (AI/C.)
- Device for the bending of stairs handrails helicoidally (ROS-L, ROS, ROS PLUS.)
- Device for twisting plate, square and rectangular profiles to realize ornamental welding rod (TOR.)
- Device for the realisation of ornamental coils with plate, square and rectangular profiles (ATV.)
- Others voltage and frequencies.